

Appendix 1 – Camp Reserve Master Plan (2020)

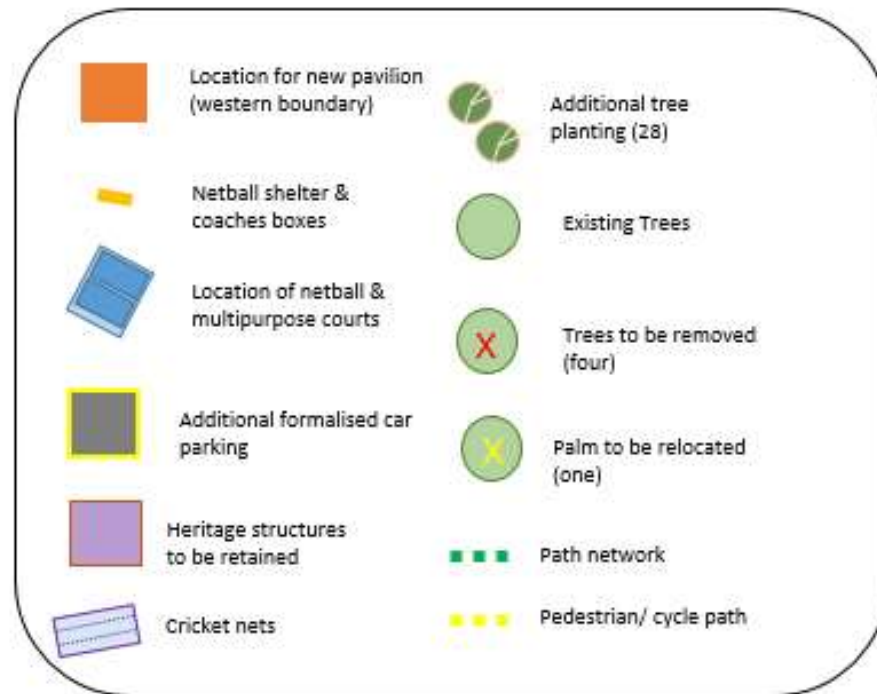

Council endorsed master plan

September 2020



CAMP RESERVE, Castlemaine.

Item	Description
1.	That the pavilion be relocated to the western flank of the reserve
2.	The design of the pavilion should include an activated street frontage to Gingell Street and an architectural consultancy with demonstrated experience working with a heritage context be engaged to design the pavilion.
3.	That the oval length is to be retained, with the shape of the playing surface to be reviewed.
4.	That the netball and multipurpose courts be located at the southern end of the reserve and that appropriate amenity and shelter is provided. i.e. clearly defined path connection to and from the pavilion, a drinking fountain, bench seats, coaches boxes and spectator viewing shelter be provided.
5.	An instruction be added to the master plan to explore opportunities for a hit up wall to be incorporated into the netball court and multipurpose court area.
6.	Officers recommend that lighting of the netball and multipurpose court be restricted and only permitted until 9:30pm.
7.	Officers recommend that as part of Council's governance processes', hire agreements be developed and administered to clubs and groups who use the pavilion requiring them to adhere to noise restrictions.
8.	That a circulation pathway plan be prepared specifically to show the required space and movement around the Reserve for the Agricultural Show events and essential services.
9.	A proposed package of works for the Agricultural Show Pavilion be developed.
10.	That a tree management plan for the Reserve be prepared prior to removal of mature and historic trees.
11.	Provision be made for the replacement of the Agricultural Show office and ticket box if it is demolished.
12.	Officers recommend that the two Eucalyptus Camaldulensis trees continue to be monitored, managed and protected for as long as practicable.
13.	The draft master plan be amended to include the incorporation of additional trees and an instruction added with regards to ensuring appropriate tree species selection. Consideration of appropriate tree varieties will be made in detailed landscape design phase.

14.	Officers recommend the provision of circa 60 additional, 90 degree formalized car parking spaces be provided within the reserve and in addition, spectator structures at key locations also be included in the revised master plan.
15.	The shared path along the eastern boundary of the reserve should be provided at a minimum of 2.5m wide, desirably at a width of 3 meters.
16.	The proposed footpath network within the Reserve should be a minimum of 1.5m wide in all locations, however typically wider (2 meters) where adjacent to the oval.
17.	In addition to further encouraging bike riding to and from the reserve, officers recommend providing bicycle hoops at the pavilion, the netball courts and the agricultural pavilion.
18.	An instruction be added to the master plan to include strategically placed seating. Final location to be subject to detailed design.
19.	An instruction be added to the master plan to include interpretive signage acknowledging Aboriginal Cultural Heritage and stories in consultation with traditional owners.
20.	An instruction be added to the master plan with regards to ensuring further consultation is undertaken at detailed design stage for major elements within the Reserve i.e. the pavilion design, agricultural pavilion, and netball and multipurpose court design.